

1、Download for App

Search for "Tuya smart" app in IOS App Store/Google Play Store or scan the QR code below to download.



2、Register / Log in with existing account

1. Register

If you **do** not have an App account yet, you can register an account or log in via SMS verification code. Please read the current page and the next page for the description of registration process.

Click "**Tuya smart APP**", enter Privacy Policy page on App, click to Agree and enter to the registration page for Mobile number or E-mail address.

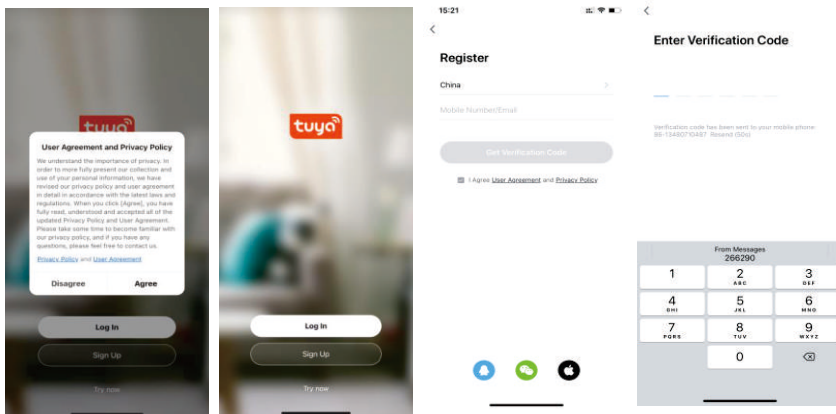

2. Log in with existing account

If you have already registered an account, you can skip the creating a new account, click "Log in with existing account", enter the log in page.

1) The system automatically select the current Country/Region, or you can manually select the Country/Region.

2) Enter your registered mobile number or e-mail address, enter your password to log in the system.

Log in with social media account.

If your phone has installed WeChat App or QQ App, click WeChat/QQ icon in the log in with social media account area. After accessing the authorization page, log in the system.

3、Add Device

Step 1: Turn on the device. Push the ON/OFF button to ON side, the blue and red lights stay on.

Step 2: Open the "Tuya smart" APP, click the "+" in the upper right corner, select "Security & Video", click "Smart Camera", and click "Next".

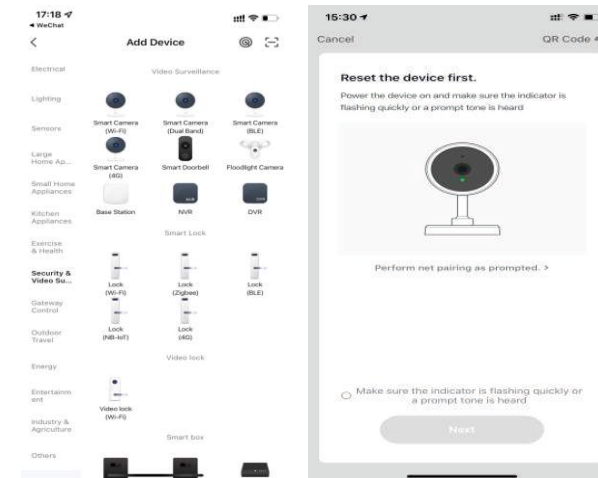

Step 3: Enter the Wi-Fi password, click "next", enter the "Camera scan QRcode" interface, the APP will automatically generate a QR code.

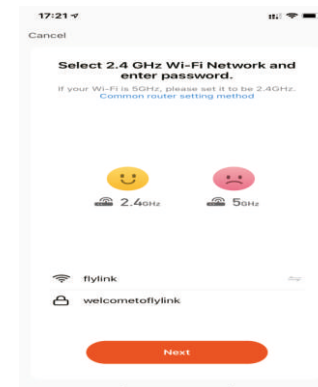

Step 4: Point the QR code generated by the APP to the camera lens (the blue light flashes slowly at this time), the device scans the code successfully (the blue light stay always on), click "I heard a prompt" to enter the network connection interface.

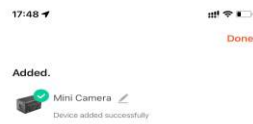
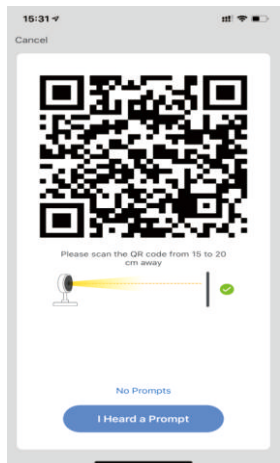

Step5: The network connection is successful, the **blue** light is always on, click "Done" to enter the video interface.

5、 Function description

Real-time preview interface

1. Setting & Management
2. Wi-Fi signal strength
3. Sound switch
4. SD/HD
5. Full screen
6. Screenshot
7. **Speak**
8. **Record**
9. **Playback**
10. **Cloud storage**
11. **Alarm**

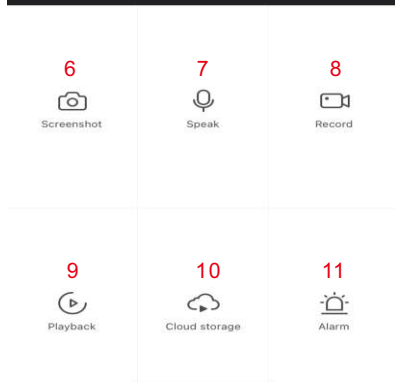
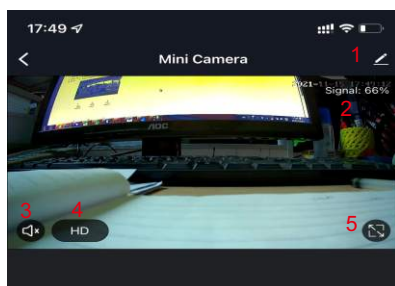

6、 Charging

Before using your camera, make sure to charge its built-in rechargeable battery.

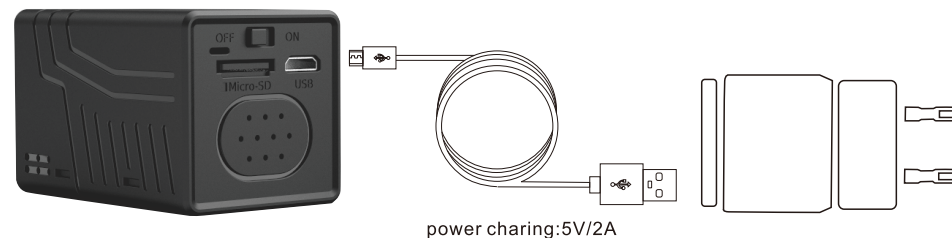

7. The status of LED light

Yellow light:

Long bright: Under charging
Off: Full charge

Red light:

Flash slowly: Waiting for connection

Blue light:

Long bright :Camera is connection WiFi